

SERVED WITH LOTS OF WATER

# CONFERENCE CENTER

## AMENITIES OVERVIEW

RAMADA Tropics Resort & Conference Center's comfortable and functional space will provide the perfect environment for your meeting, wedding or family gathering.

Our 5,200 sq. ft. ballroom will accommodate up to 360 guests at banquet round tables. The ballroom can be divided into three sections to suit your special needs. Additionally, 2,000 sq. ft. of flexible breakout space is available in our four salons. Please flip over the page to view the floor plan and get specific information about each individual conference room.

A variety of catering options are available. Whether you are planning a banquet, rehearsal dinner, convention or reception, our skilled and attentive staff will work with you to ensure that your expectations are met in every way.



## CONFERENCE CENTER FLOOR PLAN

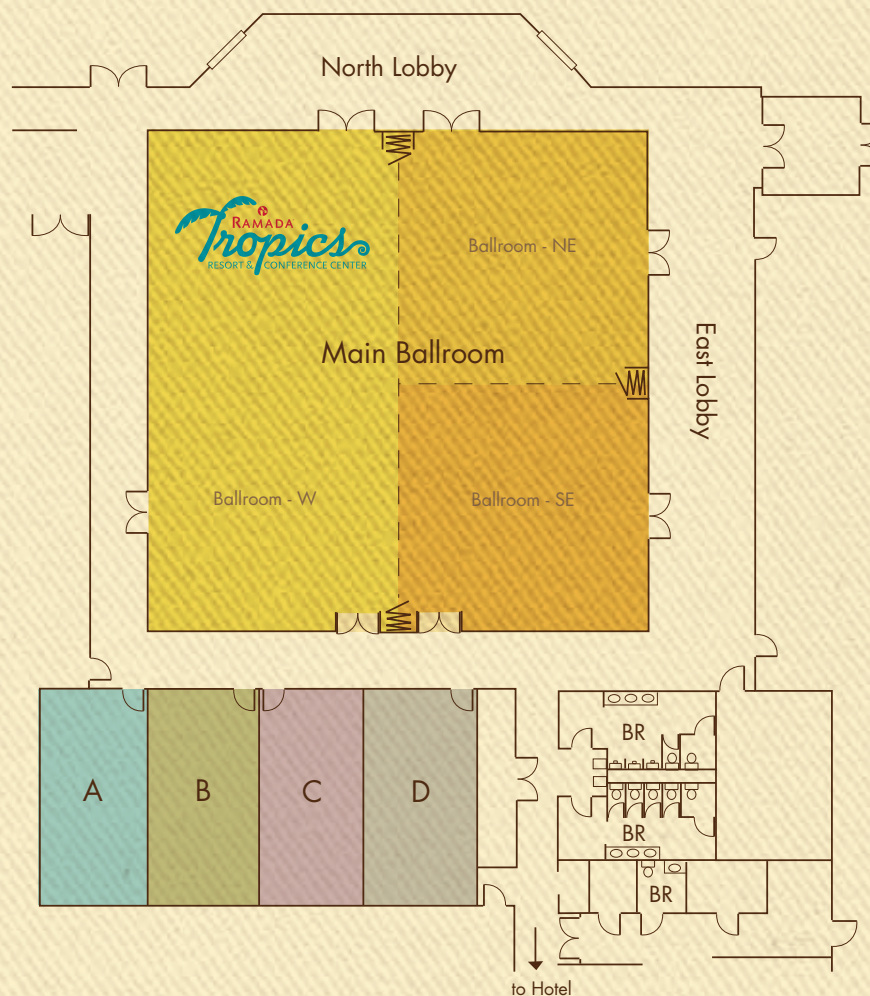

| Room          | Sq. Ft. | Dimensions    | Banquet | Classroom | Theater |
|---------------|---------|---------------|---------|-----------|---------|
| Main Ballroom | 5200'   | 73'2" x 73'2" | 360     | 250       | 500     |
| Ballroom - NE | 1300'   | 36'6" x 37'1" | 90      | 64        | 125     |
| Ballroom - SE | 1300'   | 36'6" x 37'1" | 90      | 64        | 125     |
| Ballroom - W  | 2600'   | 73'2" x 36'8" | 180     | 125       | 250     |
| Salon A       | 490'    | 15'6" x 31'4" | 30      | 24        | 60      |
| Salon B       | 490'    | 15'6" x 31'4" | 30      | 24        | 60      |
| Salon C       | 490'    | 15'6" x 31'4" | 30      | 24        | 60      |
| Salon D       | 490'    | 15'6" x 31'4" | 30      | 24        | 60      |
| Salon A & B   | 980'    | 31'2" x 31'4" | 60      | 40        | 100     |

Additionally, our pre-conference space in the north and east lobbies offers 2500 sq. ft. of space for exhibits, registrations or cocktail receptions.